

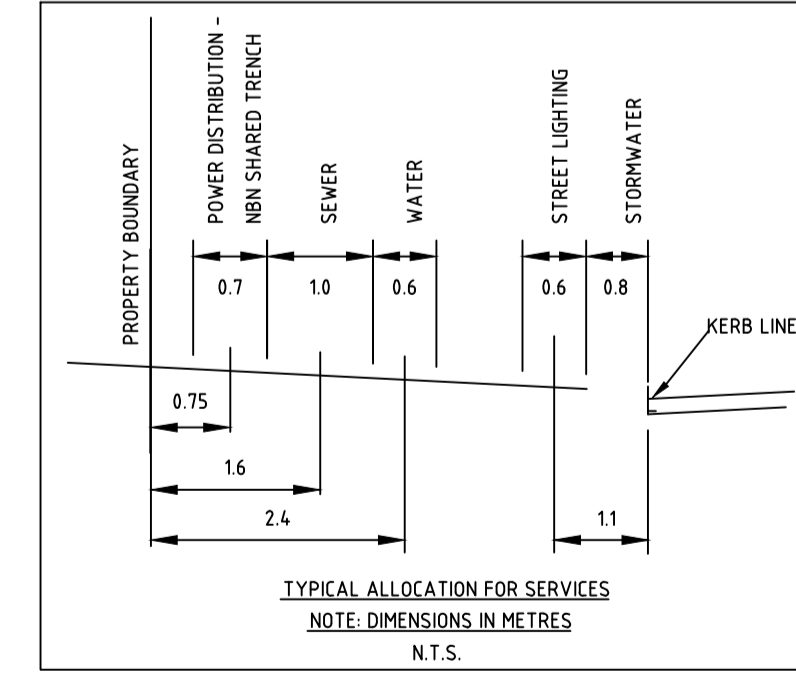

PRELIMINARY ISSUE VERSION: 1
NOT TO BE USED FOR CONSTRUCTION 27.09.2020

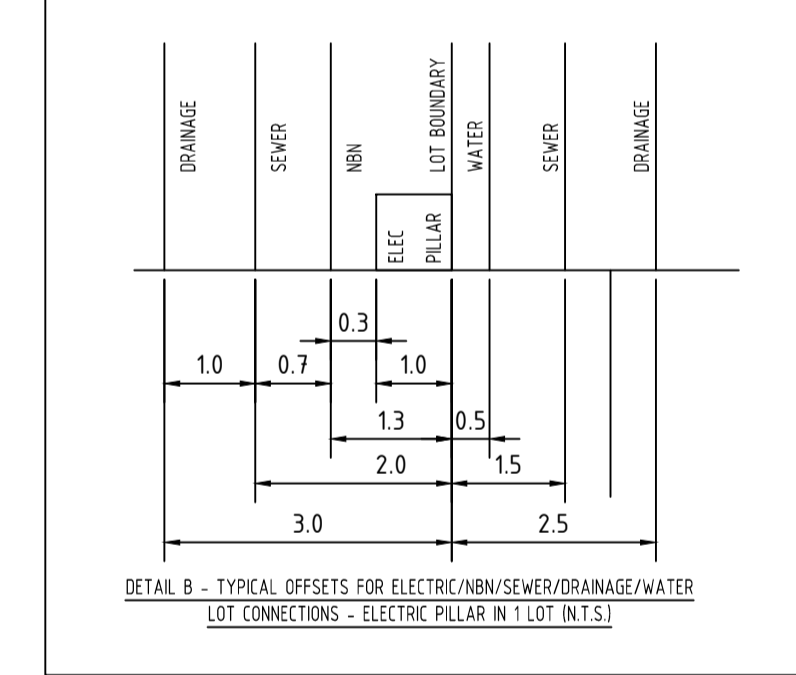
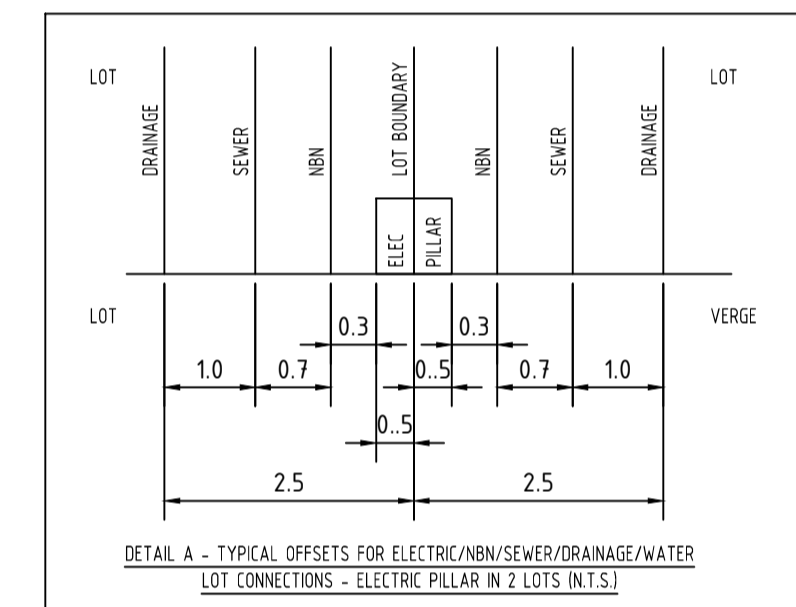
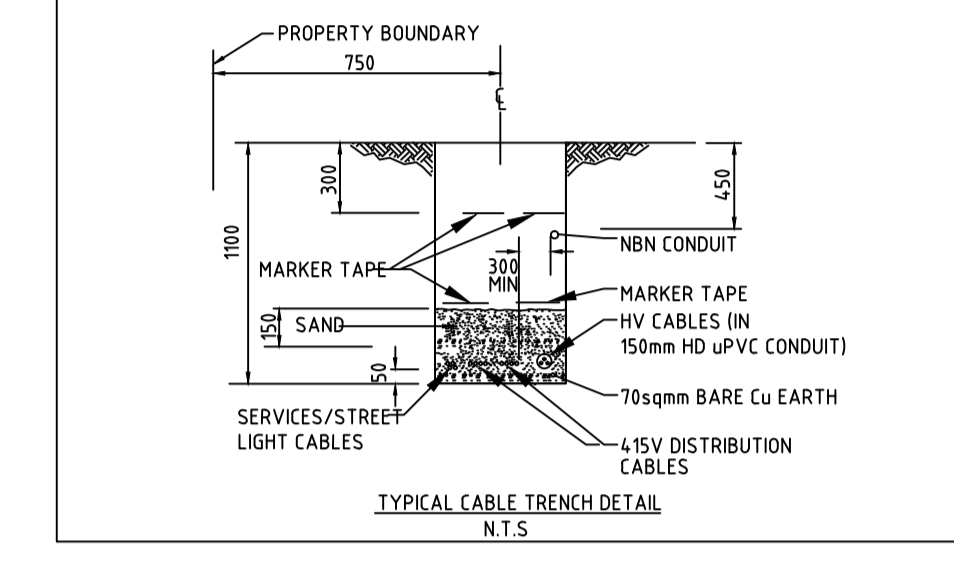
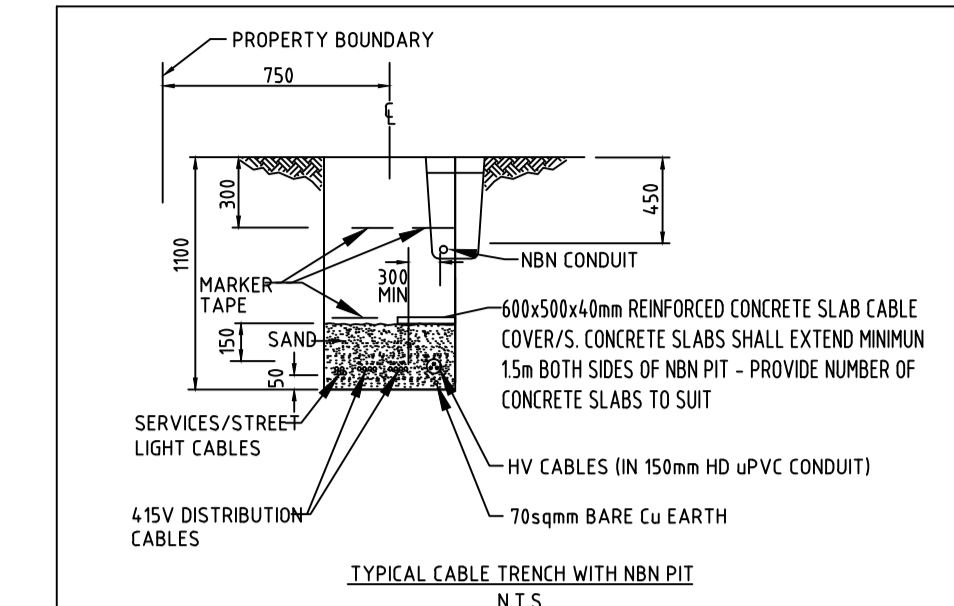
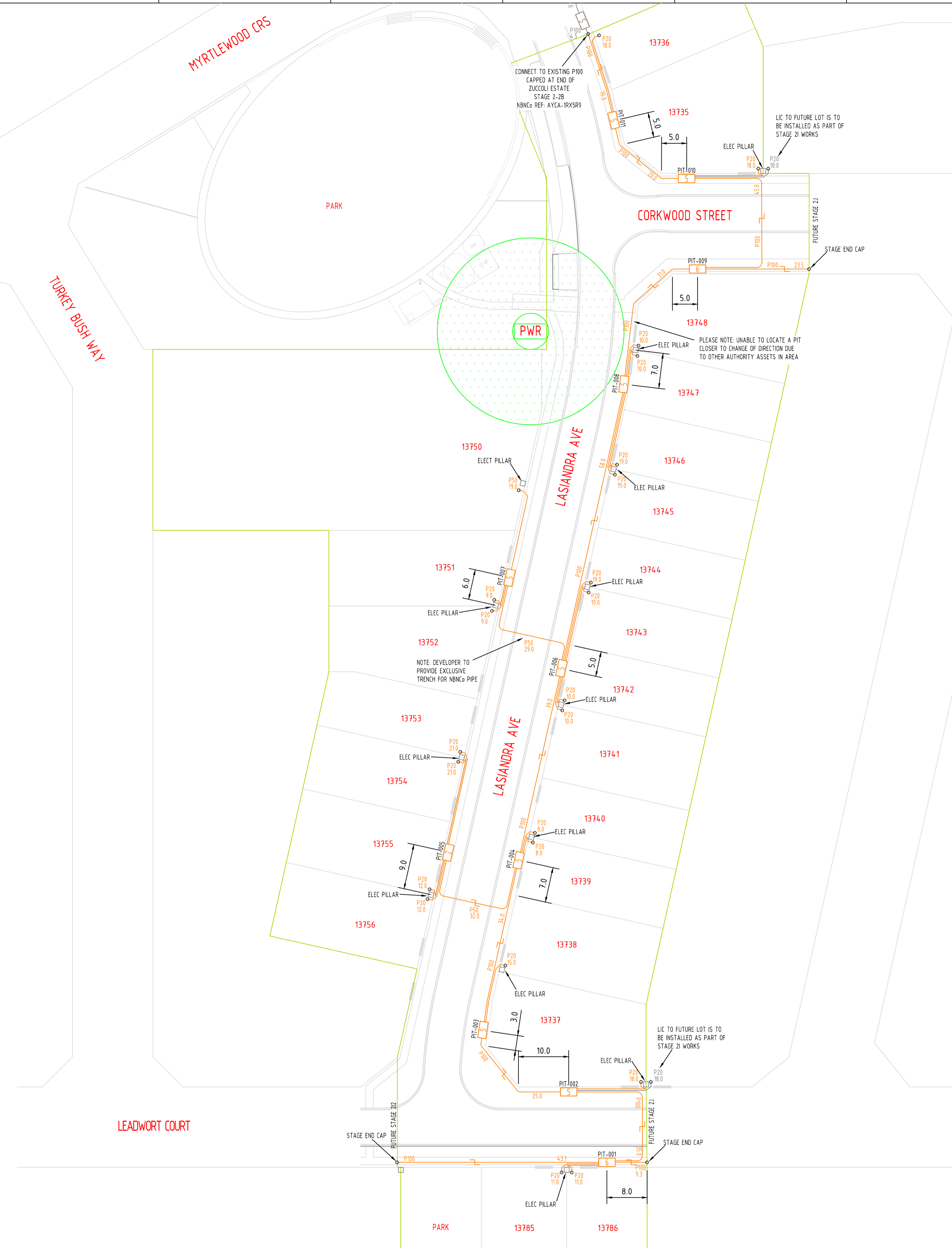

PIT LEGEND

Shared Trench Symbol

PIT-ID 2	Service Drop Access Pit
PIT-ID 5	Network Boundary/Local Network Pit
PIT-ID 6	Distribution/Local Network Connection Pit
PIT-ID 8	Distribution/Local Network Connection Pit
PIT-ID 9	Fibre Distribution Hub Pit

PIT LIDS TO BE LABELLED "NBN".

CONSTRUCTOR IS TO ENSURE PITS ARE INSTALLED IN NON-TRAFFICABLE AREAS, AT LEAST 15m AWAY FROM EPR ZONES AND CLEAR OF OTHER AUTHORITY EASEMENTS.

SERVICES CLEARANCES

SERVICES ITEM	MINIMUM RADIAL CLEARANCES
GAS - LARGE MAIN (OVER 110mm DIA)	300mm
SMALL MAIN (110mm DIA OR LESS)	150mm
ELECTRICAL - HIGH VOLTAGE	300mm
LOW VOLTAGE	100mm*2
WATER - HIGH CAPACITY MAIN	300mm
LOCAL RETICULATION	150mm
SEWER - MAIN	300mm
CONNECTION PIPE	150mm
OTHER TELECOMMUNICATIONS	100mm*1
DRAINAGE - MAIN	300mm
CONNECTION PIPE	150mm

*1 - REDUCED SEPARATION IS POSSIBLE WHERE ALL PARTIES ARE CONSULTED AND AGREEMENT IS REACHED
*2 - ONLY WHERE PROTECTION BARRIERS ARE USED, FOR EXAMPLE, CONDUIT, BEADING, MARKER TAPE & COVER BATTEN

PCD / NTD LOCATIONS

P20 LEAD-IN LOCATIONS ARE INDICATIVE ONLY, AND ARE TO BE CONFIRMED AT TIME OF CONSTRUCTION.

FOR LOCATION REQUIREMENTS REFER TO NBN DOCUMENT: NBN-DES-STO-0011

RESIDENTIAL PREPARATION AND INSTALLATION: SINGLE DWELLING UNITS (SDUs) AND MULTI DWELLING UNITS (MDUs)

ISSUE DATE: 12 DEC 2016 REVISION NO. 11.0

DESIGN & INSTALLATION SPECIFICATIONS

THIS DESIGN IS TO BE READ IN CONJUNCTION WITH NBN DOCUMENT: NBN-TE-CTO-194

"NEW DEVELOPMENTS: DEPLOYMENT OF THE NBN PIT AND CONDUIT NETWORK"

ISSUE DATE: 08/12/2017, REVISION: 8

ALL DEPLOYMENT WORKS TO BE COMPLETED TO NBN SPECIFICATIONS AS OUTLINED IN THE ABOVE DOCUMENT

SDU Development Information

Development Name: MITCHELL CREEK GREEN
Developer Company: BELLAMACK PTY LTD
Development Address: MYRTLEWOOD CRS, ZUCCOLI, NT
Authorised Rep: THOMAS NOONE
Phone: 08 8982 4800
E-Mail: Thomas.Noone@jacobs.com

nbn Reference Number: STG-W000158751
Stage Number: 211
Design Revision: A

BILL OF MATERIAL

NO OF LOTS: 23

PITS		DUCTS		
SIZE	QTY	SIZE	QTY	MTRS
2	1	P100	12	382.2
5	8	P50	3	80.0
6	2	P20	22	307.0
8	0			
9	0			

TOTAL NUMBER OF PITS: 11
TOTAL NUMBER OF MANHOLES: 0
TOTAL NUMBER OF CONDUITS: 37
TOTAL LENGTH OF CONDUITS: 769.2



REV	DATE	DRAFTER	DESCRIPTION	APPROVED
A	27.09.2020	KT (G3NS)	INITIAL DESIGN OF INTENT	SM (G3NS)

STRICTLY CONFIDENTIAL

NBNC APPROVAL RECORD:

SIGNATURE	DATE
<input type="checkbox"/> DD	_____
<input type="checkbox"/> WD	_____
<input type="checkbox"/> AB	_____

QUALITY RECORD:

NBNC DISCLAIMER
THIS DOCUMENT HAS BEEN PREPARED SOLELY FOR THE USE OF NBNC LIMITED (ABN 86 136 533 741) FOR USE IN MAINTAINING NBNC FACILITIES. IT HAS NOT BEEN CREATED FOR ANY OTHER USE. IT SHOULD NOT BE SCALED TO LOCATE NBNC ASSETS. NO WARRANTY IS GIVEN THAT THE INFORMATION IS ACCURATE OR COMPLETE.

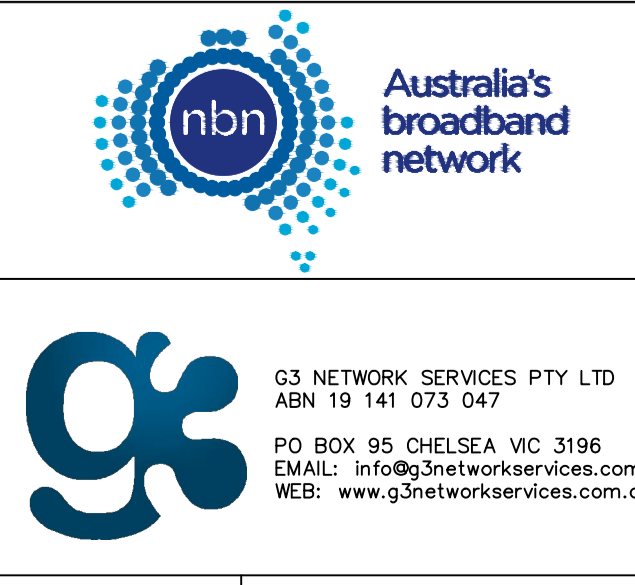

KEY PLAN

DRAWING TITLE: NBN PIT & PIPE DESIGN
MITCHELL CREEK GREEN STAGE 211
ZUCCOLI
23 LOTS

ENABLE#: 277108

STATE: NT REGION: _____

FSA: _____ SAM: _____ ADA: _____

PROJECT No: STG-W000158751

CADREF No: G3NS3513

SCALE: N/A SHEET No. 1 OF 1 REV. A