

GIFTED ASSETS

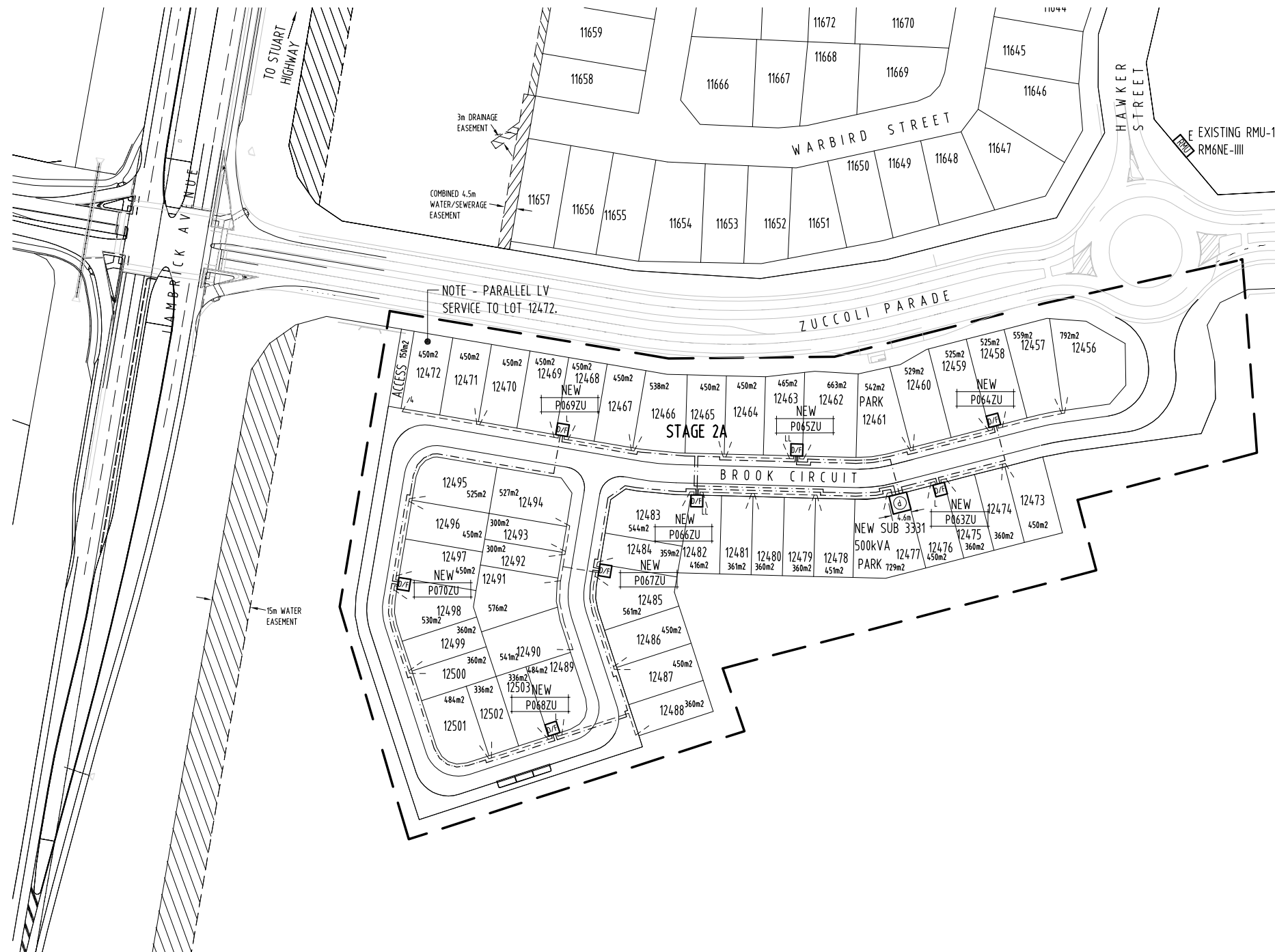

WARNING
BEWARE OF EXISTING UNDERGROUND SERVICES.
CONTRACTOR SHALL CONFIRM LOCATIONS OF SERVICES
PRIOR TO EXCAVATION. COORDINATE WITH
ALL RELEVANT AUTHORITIES.



SITE PLAN (1:1000 AT A1)

NOTES

- 1 - REFER DWG No. B14-7246 FOR DETAILS OF ITEMS LISTED IN LEGEND.
- 2 - LV CABLING SHALL BE RUN BELOW (DEEPER THAN STANDARD ELECTRICAL TRENCH DEPTH/COVER) SEWER AND/OR STORMWATER MAINS WITH A MINIMUM OF 300mm CLEARANCE AT CROSSOVER LOCATIONS. COORDINATE ON SITE WITH CIVIL CONTRACTOR.
- 3 - MINIMUM 300mm HORIZONTAL SEPARATION REQUIRED BETWEEN EDGE OF NBN Co. CONDUIT/S & LV CABLING. TRENCH WIDTH MAYBE EXTENDED BY 200mm TOWARDS PROPERTY BOUNDARY TO ENSURE 300mm HORIZONTAL SEPARATION PROVIDED. WHERE 300mm SEPARATION NOT PROVIDED, LV CABLING SHALL BE INSTALLED IN 100mm HD uPVC CONDUIT. ALSO REFER DWG No. B14-7241, DETAILS B & C.

LEGEND

- EXISTING RING MAIN UNIT.
- PACKAGE SUBSTATION (RATING AS SHOWN).
- DISTRIBUTION DOUBLE LINK PILLAR - FUSED TYPE.
- DISTRIBUTION LINK PILLAR - FUSED TYPE.
- DISTRIBUTION PILLAR - FUSED TYPE.
- LV DISTRIBUTION CABLE - 0.6/1kV 4 x 1C 240 Sq mm AL, XLPE/NJ/PVC & 1 x 1C 70 Sq mm Cu, BARE EARTH - DIRECT BURIED (OR WITHIN CONDUIT AT ROAD CROSSING). ALSO REFER NOTE 3.
- LV SERVICE CABLE - 0.6/1kV 2 x 1C 25 Sq mm Cu, XLPE/NJ/PVC - DIRECT BURIED (OR WITHIN CONDUIT AT ROAD CROSSING). ALSO REFER NOTE 3.
- PARALLEL LV SERVICE CABLE - 0.6/1kV 4 x 1C 25 Sq mm Cu, XLPE/NJ/PVC - DIRECT BURIED (OR WITHIN CONDUIT AT ROAD CROSSING). ALSO REFER NOTE 3.

PILLAR SCHEDULE		
PILLAR	630A STRIPPLE FUSE UNIT	160A STRIPPLE FUSE UNIT
P063ZU	2	2
P064ZU	1	2
P065ZU	3	2
P066ZU	3	2
P067ZU	1	3
P068ZU	2	2
P069ZU	2	3
P070ZU	1	2

CONTRACTOR:
NORTHERN POWER SERVICES
PO BOX 1844
PALMERSTON NT 0831
PHONE: 8932 9317
FACSIMILE: 8932 9346

DEVELOPER:
TERRITORY LIFE
GPO Box 1782
DARWIN NT 0801
PHONE: 8943 0641
FACSIMILE: 8941 0848
EMAIL: nlouw@rspm.com.au
CONTACT: HERMANUS LOUW



GPO BOX 3097
DARWIN NT 0801
TELEPHONE: 08 89416582
FACSIMILE: 08 89421400
EMAIL: aleky@agaeng.com.au

NO	DESCRIPTION	DRN	DATE	APPD	DRG NO	TITLE
D	AS CONSTRUCTED		15-10-14	A.G.	B14-7247	SINGLE LINE DIAGRAM & LEGEND
C	ISSUED FOR CONSTRUCTION		24-7-14	A.G.	B14-7246	NOTES, HV SCHEMATICS & POLE SCHEDULE
B	ISSUED FOR POWER AND WATER APPROVAL		10-7-14	A.G.	B14-7245	MASTER SERVICES PLAN
A	ISSUED FOR POWER AND WATER REVIEW		16-6-14	A.G.	B14-7244	CONDUIT/POLE LAYOUT
					B14-7243	STREET LIGHTING RETICULATION
					B14-7241	HV ELECTRICAL RETICULATION

DRAWING STATUS		APPD	DATE
P	PRELIMINARY/PROPOSED		
T	TENDERING PURPOSES ONLY		
AC	APP. FOR CONSTRUCTION		
AI	AS INSTALLED		
C	CANCELLED/SUPERSEDED		

DES	A.GANGUR	POWER NETWORKS - PALMERSTON DISTRIBUTION SUBDIVISION OF LOT 12087
DRN	K.TAVENER	
CKD	A.GANGUR	
APPD		ZUCCOLI SUBDIVISION - STAGE 2 : STAGE 2A LV ELECTRICAL RETICULATION
SCALE	1:1000 AT A1	
ISSUED	15-10-14	
ALL DIM. IN mm		
DRAFTING STANDARD TO A.S.1100		

A1 DRAWING NUMBER **B14-7242**



FILE No: NE590/12087